

# ROCK BOX

the party room!

Thank you for considering the Rock Box party room for your event! This document contains details about the space as well as important information about rates, policies and washington laws. If you have further questions, give us a ring at 206.302.7625 any day after 4pm.

## capacity

For maximum comfort, we suggest limiting guests to 35, however we have hosted larger groups. If you think you need more space, consider booking one or more additional rooms.

## features of the space

- 60" plasma TV
- projector to display karaoke or other media on north wall
- small stage
- state-of-the-art surround sound
- user-controlled LED and laser dance lighting
- direct TV and av/media capabilities upon request

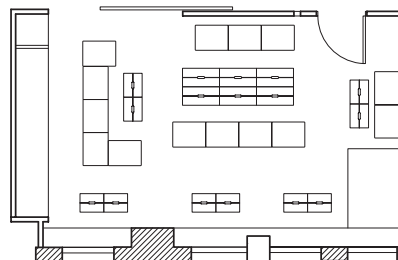

## our karaoke system

We have approximately 100,000 titles and songs in 15 languages. Our Japanese (nearly 58,000 songs) and English (20,000+ songs) libraries are our most extensive. Newly released karaoke tracks are added to our system monthly. Guests can control pitch as well as sound effects like "echo".

## party room rates, booking deposit + cancellation policy

Sunday through Wednesday: \$125/hour (first two hours), \$100/hour thereafter.

Thursday: \$125/hour before 8pm, \$175/hour after 8pm (two hour minimum), \$125/hour thereafter.

Friday and Saturday: \$125/hour before 8pm and \$175/hour after 8pm (two hour minimum).

**please note** 18% gratuity is added to total charges (room fees, drinks and food).

We require a 50% (of total room fee) non-refundable deposit to book the party room. If you cancel with less than 10 days notice, we will charge the card on file the remaining room fee balance plus tax.

## fine print, additional charges, decorations

- For parties of six or more, an 18% service charge is added to the total bill (room fees, drinks and food). Sales tax is also added.
- Party room fees must be on a single check; we are happy to put food/drinks on individual tabs.
- Some decorations ok, please contact us to discuss. No glitter please.

## changes to your reservation, and late arrivals

- The room fee is a flat rate for the length of your reservation. For example, if you've booked for two hours (7 – 9pm) you will be charged for two hours regardless of when you arrive or if you leave early. This is the only way we can guarantee the room will be available for you.
- 72 hours notice is required to change in/out times (depending on availability).
- Other changes, please call (do not email) as soon as possible. We'll do our best to accommodate you.

## bar packages and catering options

- We offer several bar packages for hosted events (one check); information available upon request.
- Because Rock Box has a very small kitchen, we've partnered with local restaurateur, Thoa Nguyen of Chinoise Cafe, to cater large events. Advance ordering and one check required.

## washington laws to keep in mind

- No outside beverages (alcoholic or non-alcoholic) may be brought into Rock Box.
- Individuals from abroad (other than Canadians) must bring their passport to be admitted.
- Individuals must be 21 or older to enter.
- Customers may not be in possession of alcohol after 2am; we stop serving at 1:40am nightly.



350 sf, 25' x 15'  
ceiling is 15'- 6"  
windows on nagle



last minute  
changes?  
please call rather  
than email.  
206.302.7625